



UPDATED NOTICE: Permanent Street Closure

GLENWOOD AVE. WILL BE PERMANENTLY CLOSED AT RAILROAD CROSSING

REVISED START DATE: JANUARY 26, 2021 (CITY OF GLENDORA)

CONSTRUCTION ACTIVITY

Crews will be permanently closing Glenwood Ave. and creating cul-de-sacs on both sides of the railroad crossing in the city of Glendora, as part of the 9.1-mile Foothill Gold Line light rail project. Construction crews will rebuild the existing roadway and add new curb, gutters, fencing, and soundwalls. The permanent closure is required by the California Public Utilities Commission to improve safety along the corridor. Following the permanent closures, crews will continue to build the project within the railroad corridor.

WHEN

Starting January 26, 2021, Glenwood Ave. will be permanently closed to all traffic (vehicular and pedestrian) at the railroad crossing. Work will continue within the railroad corridor at Glenwood Ave.

- Crews will work daily 7:00 AM - 5:30 PM, Monday thru Saturday. NOTE: Occasional longer working hours may be needed (per the city's municipal code, which allows working hours: 7:00 AM - 9:00 PM, 7 days a week).

TRAFFIC ADVISORIES

- Glenwood Ave. will be fully and permanently closed to vehicular and pedestrian traffic at the railroad crossing north of Route 66 and south of Lemon Ave.
- Access to homes and businesses on Glenwood Ave. north and south of the railroad crossing will be maintained during construction.

PLAN YOUR ROUTE AND BE PREPARED

- Permanent closure signage will be placed on Glenwood Ave. to direct motorists and pedestrians. Please follow signage.
 - ✓ Glenwood Ave. will be fully closed to all traffic at the railroad crossing between Route 66 and Lemon Ave.
 - ✓ Elwood Ave. (northbound and southbound) will remain open to all traffic.
 - ✓ Lemon Ave. (eastbound and westbound) will remain open to all traffic.
 - ✓ Route 66 (eastbound and westbound) will remain open to all traffic.

NOTE TO RESIDENTS / BUSINESS OWNERS

- Noise from construction equipment will be produced near the active work zones.
- Bus stops may be temporarily relocated, for more information:
 - Foothill Transit Bus: (800) RIDE-INFO/ (800) 743-3463 or foothilltransit.org
 - Metro Bus: (323) GO-METRO/ (323) 466-3876 or www.metro.net

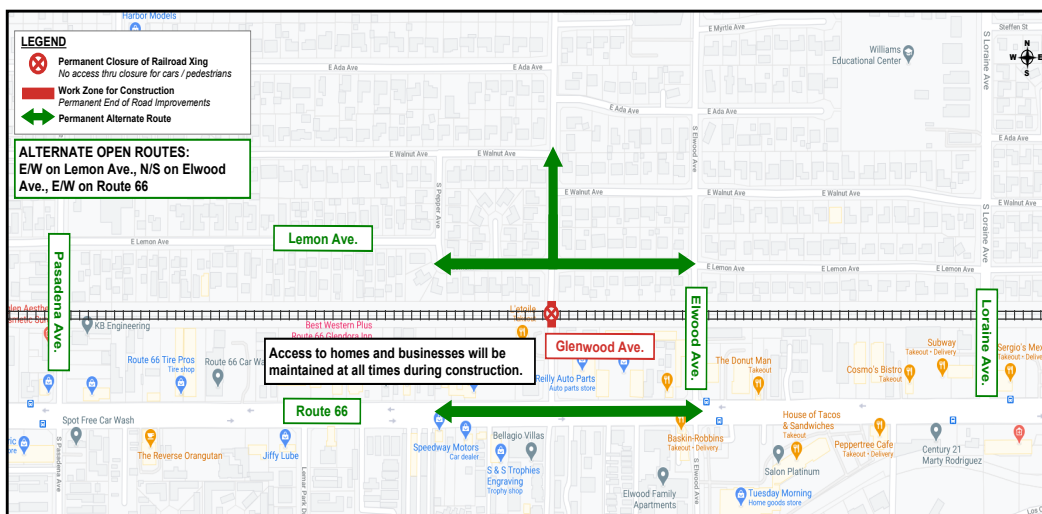

STAY SAFE

Please obey all posted construction signs and do not enter the construction work zone.

Para información en español por favor llame o envíe un mensaje de texto a (626) 513-5788.

QUESTIONS?

Project Construction Questions Hotline: (626) 513-5788 **Email:** CommunityRelations@Kiewit-Parsons.com

General Project Questions: (626) 471-9050 **Email:** PublicAffairs@Foothillgoldline.org

Stay ahead of construction, sign up for alerts: www.foothillgoldline.org

**Construction schedules are subject to change for various reasons, including, but not limited to, weather conditions and unforeseen delays.*